

## SPECIFICATION

# Active GA 4

4 Zones GSM Alarm Panel with 64 Bits LCD display

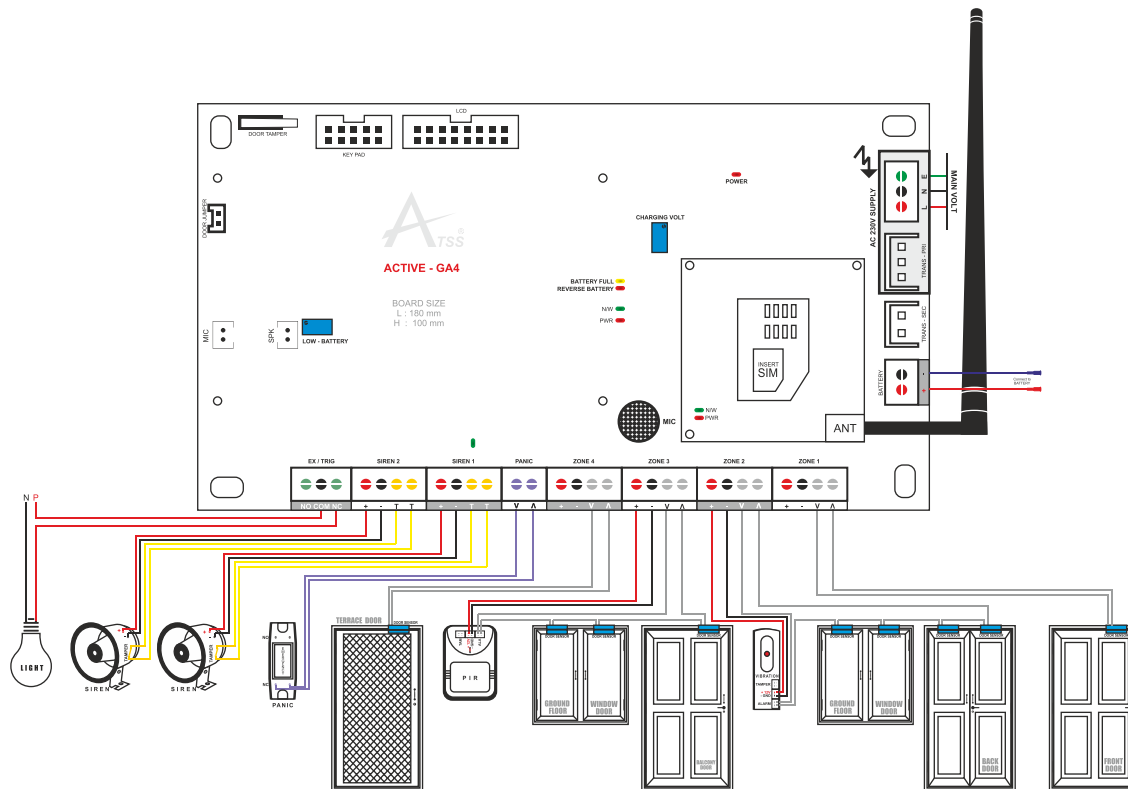

### POWER SUPPLY

Max Power Consumption	36 Watts
AC Main Supply	220-240 V AC /50 Hz
Transformer-Step down	230 V AC/50 Hz(Pri) 18 V AC /2 A (Sec)

### BATTERY

Battery type	Battery is fully recommended Lead Acid Rechargeable Battery
Max Recharging Voltage-Input	13.7 V DC
Max Voltage/Current ratings	12 V DC/7 AH

### ZONES

Zone Response Time	< 500 Millisecond
Zone Loop Resistance	< 1kilo Ohm For Normally Closed
Max Output Voltage/Current for Sensor Supply	12 V/500 MA
Max Output Voltage/Current for Siren Supply	12 V/750 MA
Max Length of Sensor Cable (multi core cable)	150 m (Depends on cable resistance)
Max Length of Siren Cable (multi core cable)	75 m (Depends on cable resistance)
GSM Antenna	5 dB Required

### RELAY-NORMALLY CLOSED

Max Output Voltage/Current	AC 240 V/ 5 A
----------------------------	---------------

### ENVIRONMENTAL

Environment	Residential/ Commercial/ Light Industrial
Max Humidity	95% Non-Condensing
Operating Temperature	0°C To 45°C
Storage Temperature	-20°C ~ + 60°C

### PHYSICAL

Colour	Grey Coloured Metal Box
Control Panel Dimensions(mm)	(H X W X L) = 230 X 95 X 330
Weight	3.4kg